

Cotter Pins

Low Carbon Steel

PC020---X---Z1

Stainless Steel

PC188---X---

Brass

PCBRS---X---

Comp. Num	Nom Size		T		W		B	A	Hole Size
			Pin Diameter		Wire Width		Head Diam	Length	
			Max	Min	Max	Min	Min	Min	
003	1/32	.031	.032	.028	.032	.022	0.06	.01	.047
004	3/64	.047	.048	.044	.048	.035	0.09	.02	.062
006	1/16	.062	.060	.056	.060	.044	0.12	.03	.078
007	5/64	.078	.076	.072	.076	.057	0.16	.04	.094
009	3/32	.094	.090	.086	.090	.069	0.19	.04	.109
010	7/64	.109	.104	.100	.104	.080	0.22	.05	.125
012	1/8	.125	.120	.116	.120	.093	0.25	.06	.141
014	9/64	.141	.134	.130	.134	.104	0.28	.06	.156
015	5/32	.156	.150	.146	.150	.116	0.31	.07	.172
018	3/16	.188	.176	.172	.176	.137	0.38	.09	.203
021	7/32	.219	.207	.202	.207	.161	0.44	.10	.234
025	1/4	.250	.225	.220	.225	.176	0.50	.11	.266
031	5/16	.312	.280	.275	.280	.220	0.62	.14	.312
037	3/8	.375	.335	.329	.335	.263	0.75	.16	.375
043	7/16	.438	.406	.400	.406	.320	0.88	.20	.438
050	1/2	.500	.473	.467	.473	.373	1.00	.23	.500
062	5/8	.625	.598	.590	.598	.472	1.25	.30	.625
075	3/4	.750	.723	.715	.723	.572	1.50	.36	.750

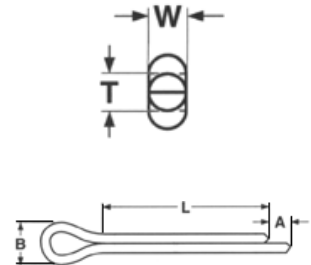

Hammer Lock Cotter Pin

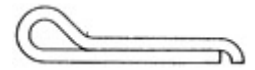

This is not a uncommon